



June 26, 2024

California Regional Water Quality Control Board
Los Angeles Region
320 W. 4th Street, Suite 200
Los Angeles, California 90013
ATTN: Information Technology Unit

**Subject: Leachate Seep Report
Chiquita Canyon Landfill
WDRs Order No. R4-2018-0172
File No. 67-020**

Pursuant to MRP No. CI-6231 Section B.3.a, Chiquita Canyon, LLC (“Chiquita”) provides the following information regarding an incident that occurred on June 19, 2024, during which leachate travelled off of the landfill’s liner but did not reach the stormwater channel.

i. Map - A map showing the location(s) of spillage.

The incident occurred above the leachate collection tanks adjacent to the Leachate Collection Manifold (the “LCM”), as indicated in Attachment A.

ii. Flow rate - An estimate of the flow rate.

The flow rate of the leachate spill began as a very light trickle, but after the line broke, as discussed in more detail below, the flow rate increased to a heavy flow for a period of 10 seconds before the line was moved into the concrete containment in the area.

iii. Description - A description of the nature of the discharge (e.g., all pertinent observations and analyses).

On June 19, 2024, at approximately 7:17 a.m., Chiquita observed a crack in a leachate line within the LCM. While vacuuming the leachate that had come from the crack in the leachate line, the line broke at approximately 7:45 a.m., which caused leachate to spill. The leachate that spilled from the leachate line was light amber in color with very low viscosity. The leachate did not reach the stormwater channel or the south sedimentation basin.

iv. Location – Location of sample(s) collected for laboratory analysis, as appropriate.

June 26, 2024

Page 2 of 2

No sampling was conducted for this small spill.

v. Corrective measures – approved (or proposed for consideration) by the Regional Board Executive Officer.

Upon release of the leachate from the broken line, Chiquita began remediation and clean-up efforts promptly by vacuuming the soil and isolating the line from the pump feeding it. The pump was then locked and tagged out so no one would use it during the remediation process. After removing the leachate-stained soil, Chiquita replaced it with clean soil. Chiquita completed the clean-up the same day the spill occurred.

Chiquita is implementing additional measures to avoid similar spills in the future. Prior to the incident, the line contained a 2” HDPE pipe surrounded by a 4” HDPE pipe, which served as another containment measure in the event the 2” pipe failed. Chiquita is modifying the piping so that in the event both pipes fail, the liquid is conveyed into a concrete containment system. The line was repaired on June 25, 2024, and has since been successfully pressure tested.

If you should have any questions regarding this report, please do not hesitate to contact me at (661) 257-3655.

Sincerely,
Chiquita Canyon, LLC

Nicole Ward
Assistant District Manager
Chiquita Canyon Landfill

Attachments: Attachment A – Grid map of the spill

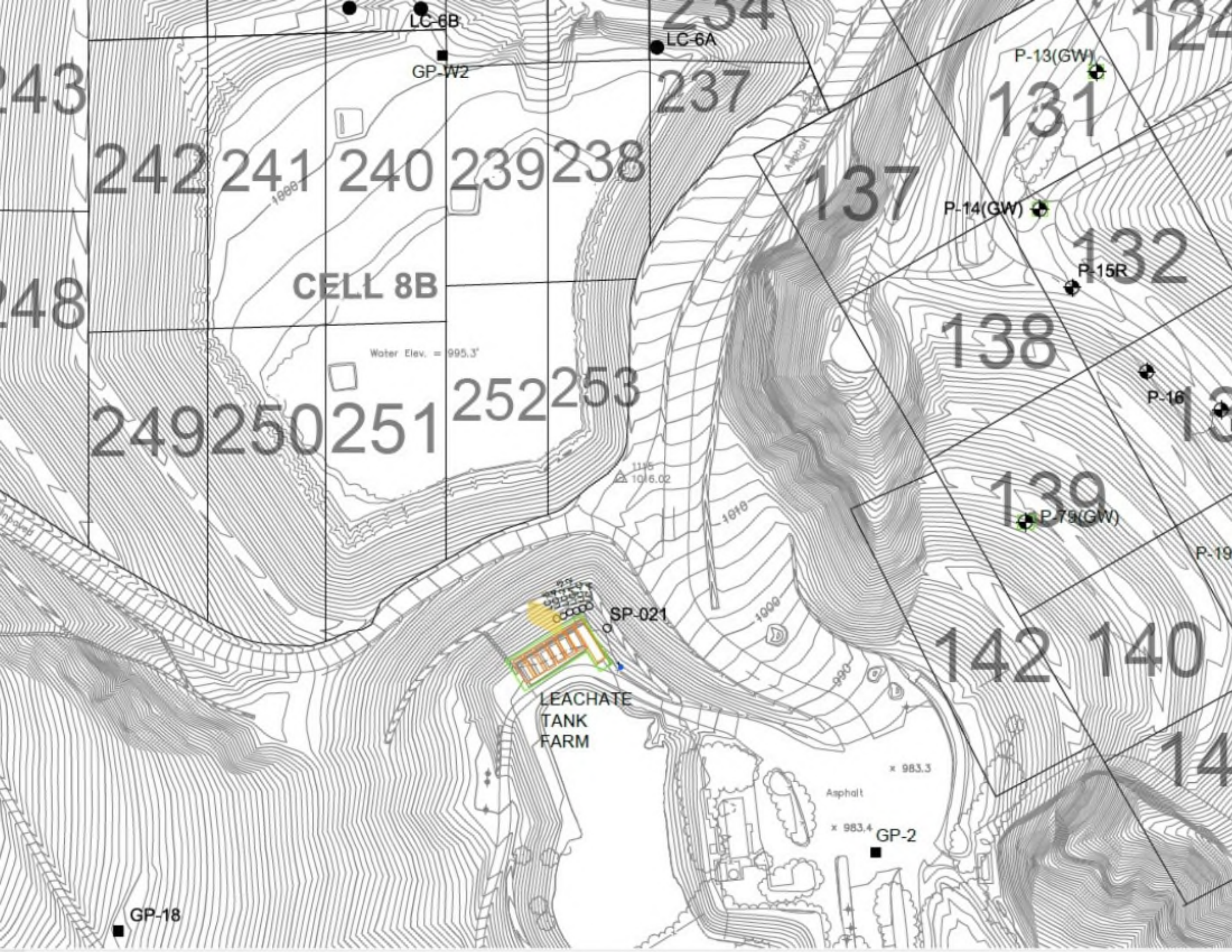

LC-6B

LC-6A

GP-W2

P-13(GW)

P-14(GW)

P-15R

P-16

P-79(GW)

P-19

SP-021

x 983.3

Asphalt

x 983.4

GP-2

CELL 8B

Water Elev. = 995.3'

LEACHATE
TANK
FARM

GP-18